



KEY BENEFITS

- 2.43 MEGAPIXEL SENSOR
- DUAL OUTPUT: AHD & ANALOG OSD
- COVERT INFRARED | 36 IR LEDS
- 4MM FIXED MEGAPIXEL LENS
- PINHOLE LENS FOR COVERT RECORDING

Record covertly with a camera hidden inside a motion detector case. This camera provides the user with crystal clear video images that can be modified from a standard analog signal to an analog high definition signal with a simple touch of the OSD joystick.

SPECIFICATIONS

Video Sensor	1/3" 2.4 Megapixel sensor
Lens	4mm Megapixel rated lens
Resolution	Digital: 1920x1080P Analog: 960H - 1200TVL
Video Output	AHD: 1080P / 960P BNC CVBS: 1.0 Vp-p Composite Signal (75 Ω)
Infrared	Covert - 36 LEDS
Electronic Shutter	AUTO/ MANUAL /FLK
Scanning System	Progressive Scan
Minimum Illumination	0.2 LUX (Color/Day) 0.01 LUX (B/W)
3D-DNR	OFF / ON (LOW/MIDDLE/HIGH)
Digital WDR	OFF / ON (Level Adjustable) (Long and short exposure)
OSD	Yes
Sens-Up	OFF / ON
White Balance	AWB/ ATW / PUSH / MANUAL
Back Light Control	OFF / ON
D-ZOOM	1.0x - 8.0x
TV System	NTSC
Defog	OFF / ON
Power Consumption	150mA
Working Temperature	-10°~ to 50°C / -14° +122 °F
Power	12V DC
Dimension(D) (H)	4.75 " x 2.75 " (inches) / 120 x 70 (mm)
Weight	1.32 (lb) / 0.6 (kg)

- Covert design
- Ball-in-Socket swivel bracket
- Highlight- Backlight compensation
- Advanced OSD menu
- Automatic gain control

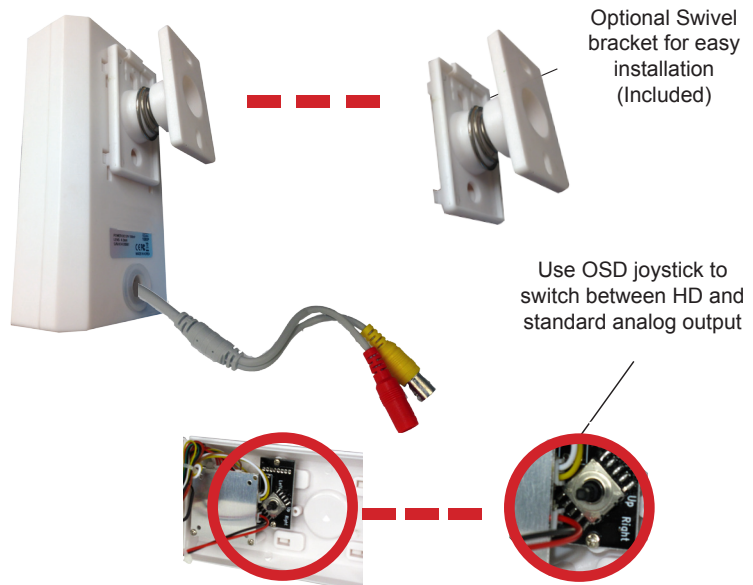

Additional OSD Options:

Exposure-wb-manual-special-cam-title-motion-privacy-park-line-image-adj-comm-adj-language-area-state-height-width-mirror-font-contrast-sharpness